

CLASSROOMS AUDIO / VISUAL GUIDE

Need Help?

Please contact KU IT at

785-864-1200

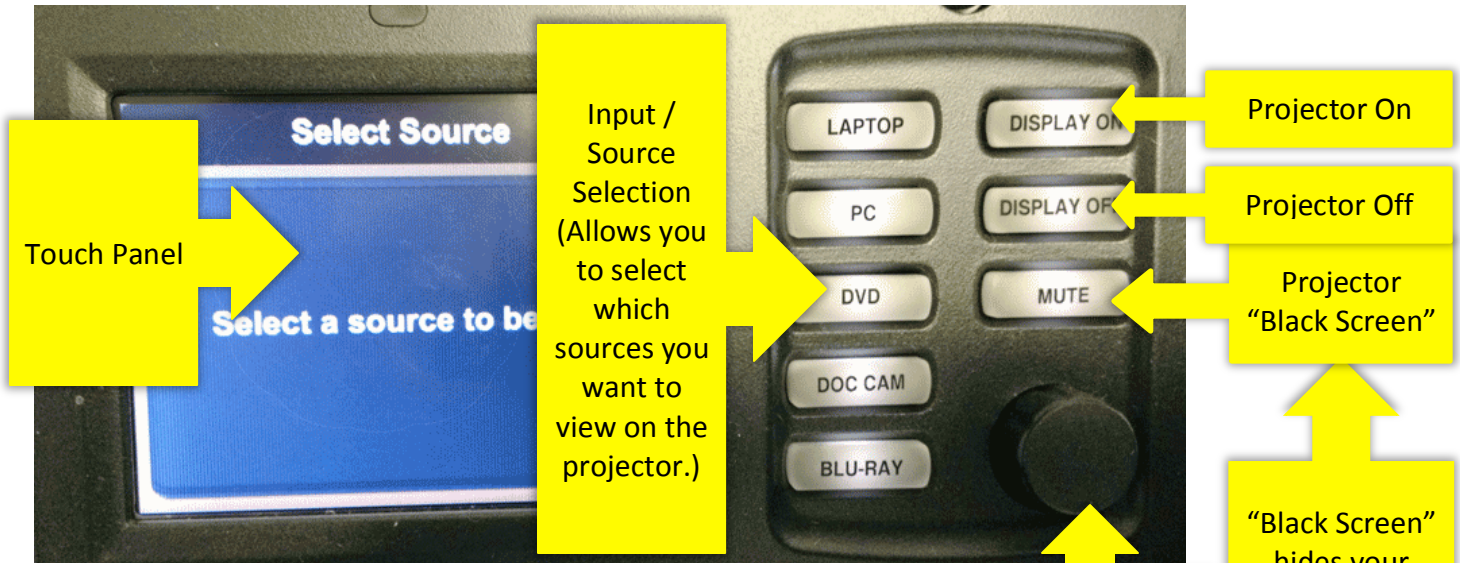

LAPTOP: To connect to your laptop, select laptop, and then select Analog or Digital Input based on the type of connector you are using. (See picture to the right.)

PC: To connect to the computer in the classroom, select PC. Then, select Analog Input. You may also have to turn on the computer by pressing its main power button.

DVD: To connect to the classroom DVD player, press the DVD button. The DVD/VHS unit may be controlled with the touch panel. To access menu functions, press "More."

DOC CAM: To connect to the document camera, press Doc Cam. You may have to also turn on the document camera.

BLU-RAY: To connect to the Blu-Ray player select Blu-Ray and use the remote in the cabinet to control the player.

Media Volume Control

Projector On

Projector Off

Projector "Black Screen"

"Black Screen" hides your presentation. Press once for on and press again to turn off.

Instructors:

Please log in using your KU Online ID and password.

Don't forget to log out. To log out, press the PC button on the A/V controller and log out on the computer.

If another class does not immediately follow yours, please turn off the projector.

Analog (VGA)



Digital (HDMI)

KU INFORMATION TECHNOLOGY
The University of Kansas

technology.ku.edu

Need help?

Classroom Support: 785-864-1200

Customer Service Center: 785-864-8080 or itcsc@ku.edu

Follow us on Twitter  @KUTechnology