

# CLASSROOMS AUDIO / VISUAL GUIDE

## Need Help?

Please contact KU IT at

# 785-864-1200

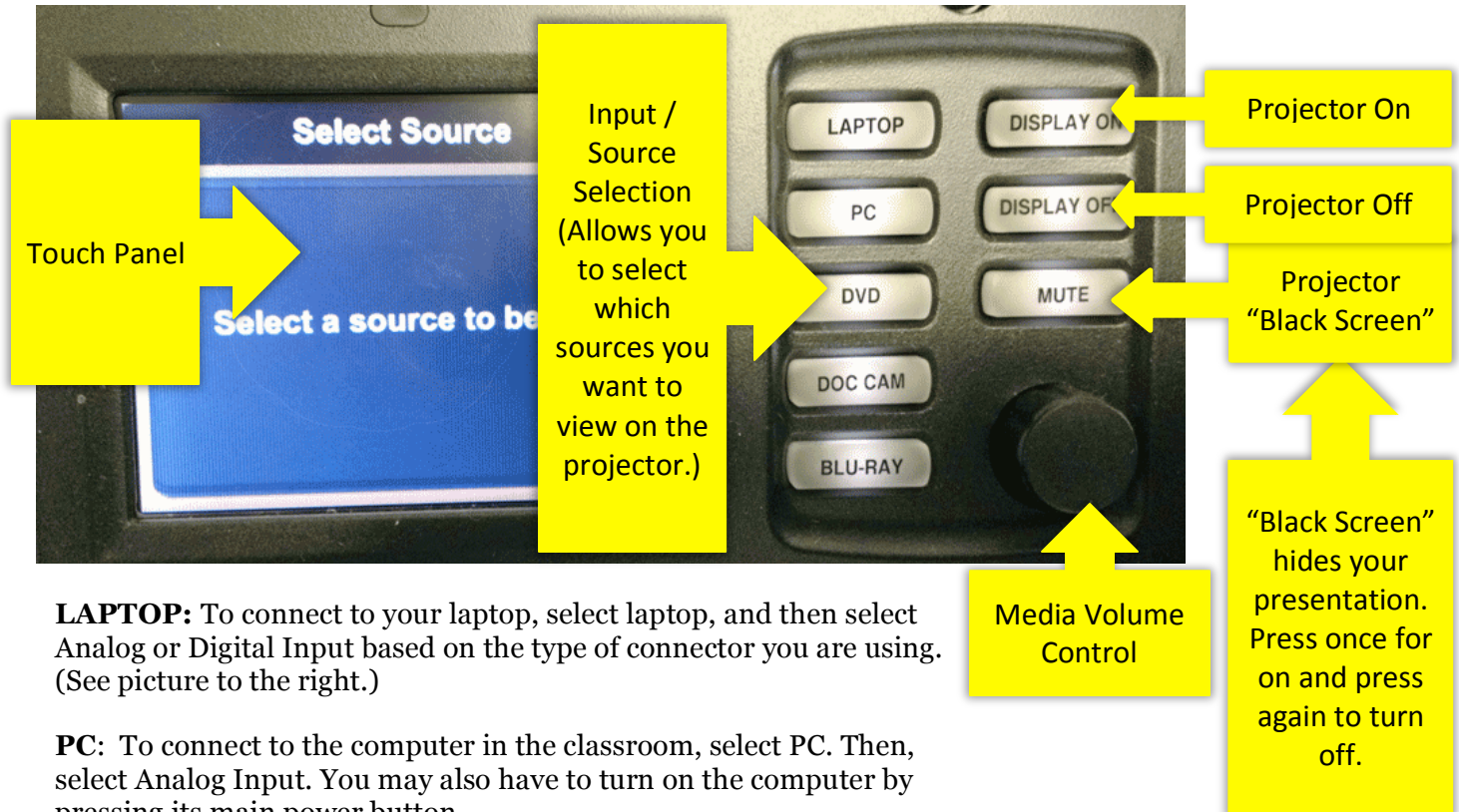

**LAPTOP:** To connect to your laptop, select laptop, and then select Analog or Digital Input based on the type of connector you are using. (See picture to the right.)

**PC:** To connect to the computer in the classroom, select PC. Then, select Analog Input. You may also have to turn on the computer by pressing its main power button.

**DVD:** To connect to the classroom DVD player, press the DVD button. The DVD/VHS unit may be controlled with the touch panel. To access menu functions, press "More."

**DOC CAM:** To connect to the document camera, press Doc Cam. You may have to also turn on the document camera.

**BLU-RAY:** To connect to the Blu-Ray player select Blu-Ray and use the remote in the cabinet to control the player.

### Instructors:

Please log in using your KU Online ID and password.

### Don't forget to log out.

To log out, press the PC button on the A/V controller and log out on the computer.

If another class does not immediately follow yours, please turn off the projector.



**KU** INFORMATION  
TECHNOLOGY  
The University of Kansas

[technology.ku.edu](http://technology.ku.edu)

### Need help?

Classroom Support: 785-864-1200

Customer Service Center: 785-864-8080 or

[itcsc@ku.edu](mailto:itcsc@ku.edu)

Follow us on Twitter  @KUTechnology

# CLASSROOMS AUDIO / VISUAL GUIDE

## Need Help?

Please contact KU IT at

# 785-864-1200

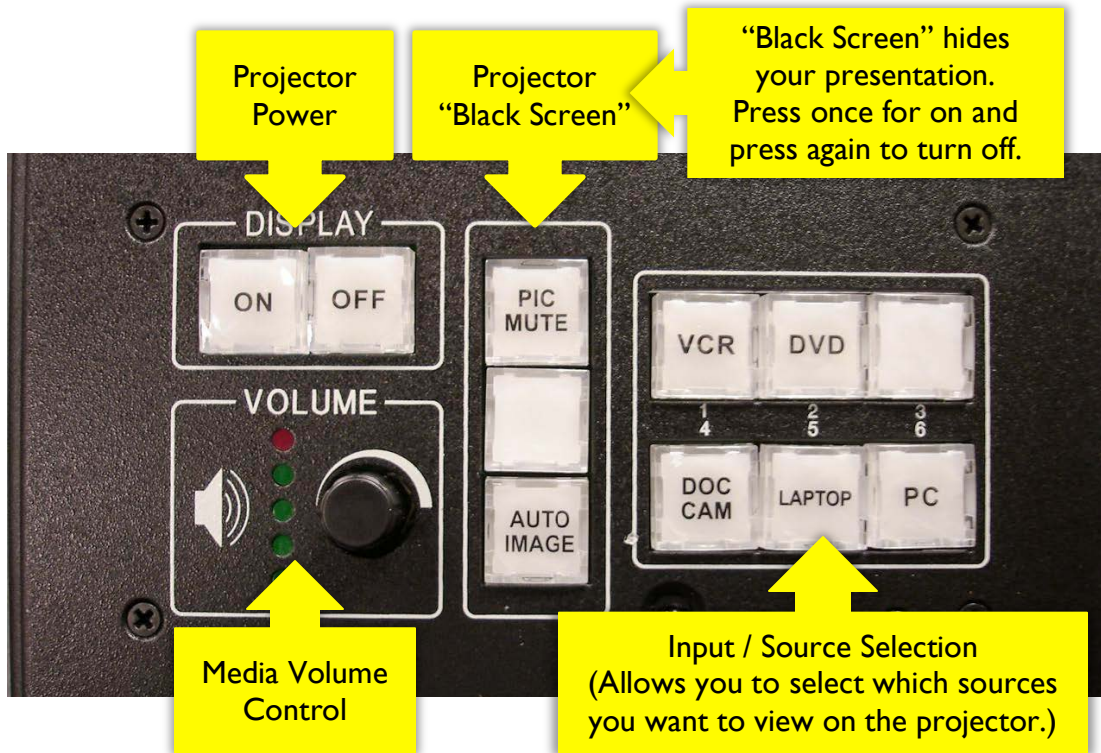

**LAPTOP:** Use the VGA cable to connect to your laptop and press the Laptop button.

**PC:** Press the PC button to connect to the computer in the classroom, select PC. You may also have to turn on the computer by pressing its main power button.

**VCR:** To connect to the classroom VCR player, press the VCR button. To control the VCR player, use the remote in the cabinet or buttons on the player.

**DVD:** To connect to the classroom DVD player, press the DVD button. To control the DVD player, use the remote in the cabinet or buttons on the player.

**DOC CAM:** To connect to the document camera, press Doc Cam. You may have to also turn on the document camera.

### Instructors:

Please log in using your KU Online ID and password.

### Don't forget to log out.

To log out, press the PC button on the A/V controller and log out on the computer.

If another class does not immediately follow yours, please turn off the projector.

### Need help?

Classroom Support: 785-864-1200

Customer Service Center: 785-864-8080 or

[itcsc@ku.edu](mailto:itcsc@ku.edu)

Follow us on Twitter  @KUTechnology