

CLASSROOMS AUDIO / VISUAL GUIDE

Need Help?

Please contact KU IT at

785-864-1200

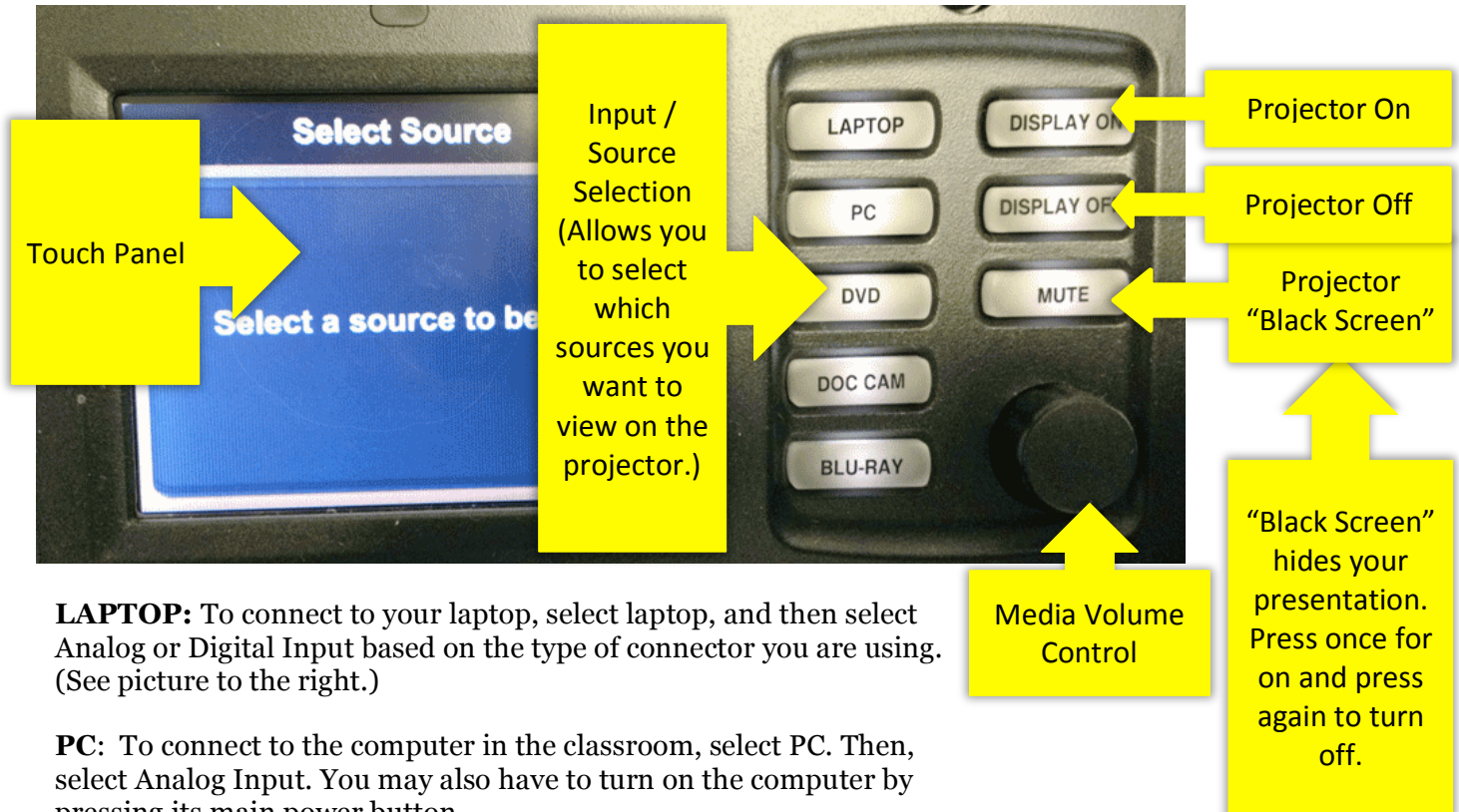

LAPTOP: To connect to your laptop, select laptop, and then select Analog or Digital Input based on the type of connector you are using. (See picture to the right.)

PC: To connect to the computer in the classroom, select PC. Then, select Analog Input. You may also have to turn on the computer by pressing its main power button.

DVD: To connect to the classroom DVD player, press the DVD button. The DVD/VHS unit may be controlled with the touch panel. To access menu functions, press "More."

DOC CAM: To connect to the document camera, press Doc Cam. You may have to also turn on the document camera.

BLU-RAY: To connect to the Blu-Ray player select Blu-Ray and use the remote in the cabinet to control the player.



Instructors:

Please log in using your KU Online ID and password.

Don't forget to log out.

To log out, press the PC button on the A/V controller and log out on the computer.

If another class does not immediately follow yours, please turn off the projector.

KU INFORMATION
TECHNOLOGY
The University of Kansas

technology.ku.edu

Need help?

Classroom Support: 785-864-1200

Customer Service Center: 785-864-8080 or

itcsc@ku.edu

Follow us on Twitter  @KUTechnology

CLASSROOMS AUDIO / VISUAL GUIDE

Need Help?

Please contact KU IT at

785-864-1200

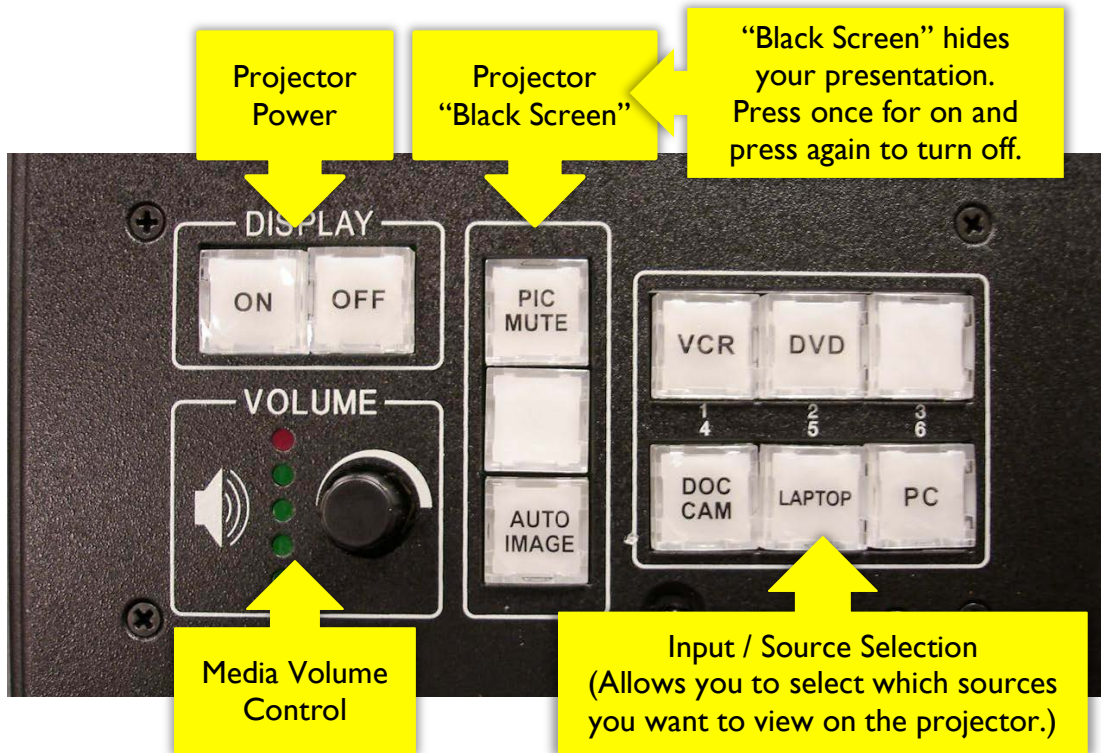

LAPTOP: Use the VGA cable to connect to your laptop and press the Laptop button.

PC: Press the PC button to connect to the computer in the classroom, select PC. You may also have to turn on the computer by pressing its main power button.

VCR: To connect to the classroom VCR player, press the VCR button. To control the VCR player, use the remote in the cabinet or buttons on the player.

DVD: To connect to the classroom DVD player, press the DVD button. To control the DVD player, use the remote in the cabinet or buttons on the player.

DOC CAM: To connect to the document camera, press Doc Cam. You may have to also turn on the document camera.

Instructors:

Please log in using your KU Online ID and password.

Don't forget to log out.

To log out, press the PC button on the A/V controller and log out on the computer.

If another class does not immediately follow yours, please turn off the projector.

KU INFORMATION
TECHNOLOGY
The University of Kansas

technology.ku.edu

Need help?

Classroom Support: 785-864-1200

Customer Service Center: 785-864-8080 or

itcsc@ku.edu

Follow us on Twitter  @KUTechnology